

Technical Data Sheet
Electric Motor 1 phase in Aluminum IE1

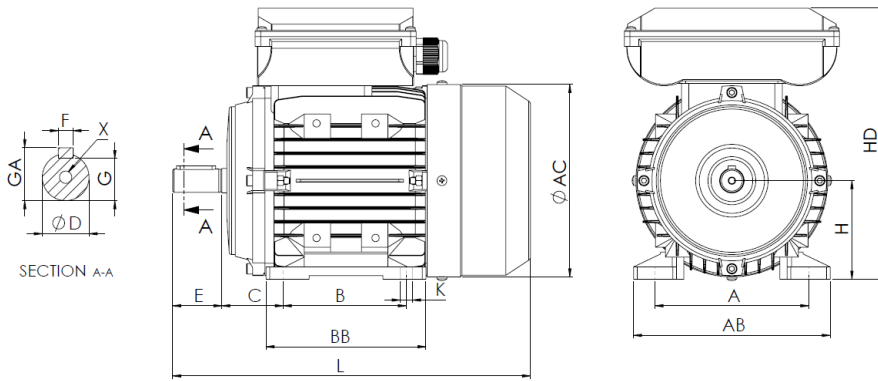

L (standard motor)
220

L (motor w/brake)
NA

L (motor w/forced ventilation)
316

L (motor without ventilation)
186

Feet					Shaft						Carcass				Flange				
H	A	B	C	K	D	E	F	G	GA	X	AB	BB	AC	HD	M	N	P	S	T
63	100	80	40	7	11j6	23	4	8.5	12.5	M4x10	120	103	121	179	-	-	-	-	-

Electrical Data				Mechanical Data			
Type	BF31D 63M1-2			Shaft height	63		
Poles	2/3000	Poles		Construction form	B3		
Power	0.18	Kw		Mechanical protection	55		
Voltage	230	V		Heating class	F		
Frequency	50	Hz		Insulation class	B		
Speed	2710	rpm		Service	S3-70%		
Nominal current	1.38	A		Ambient temp.	-10°C-40°C		
Power factor	0.90			Altitude	1000		
Efficiency 100%	63.0	%		Noise	dB(A)		
Efficiency 75%		%		Weight	3.9 kg		
Efficiency 50%		%		Bearing DE	6201 2Z C3		
Torque	0.63	N.m		Bearing NDE	6201 2Z C3		
Ta/Tn	1.8						
Ia/In	5.8						
Tm/Tn							

Extra Data

Applicable brakes

DC brake	NA	Brake torque	NA	N.m
AC brake	NA	Brake torque	NA	N.m

Applicable forced ventilations

Single-phase forced ventilation	Power	24	W
Three-phase forced ventilation	Power	NA	W

Universal Motors S.A.
Rua Comendador Brandão, 484
4495-375 Póvoa de Varzim
geral@universalmotors.pt
TEL.: 252 299 080

Universal Motors UK, Ltd
Unit E2, Meltham Mills Road
West Yorkshire HD9 4AR
enquiries@universalmotors-group.co.uk
TEL.: +44(0) 1484660222

Universal Motors SL
C/La Habana n.6 nave 4 PI Camporoso
28806 Alcala de Henares
info@universalmotors-group.es
TEL.: 918 864 213