

Technical Data Sheet
Electric Motor 1 phase in Aluminum IE1

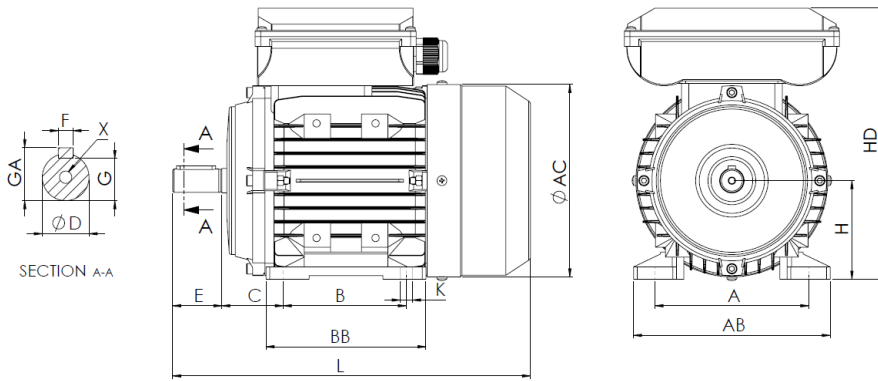

L (standard motor)

290

L (motor w/brake)

353

L (motor w/forced ventilation)

393

L (motor without ventilation)

248

Feet					Shaft						Carcass				Flange				
H	A	B	C	K	D	E	F	G	GA	X	AB	BB	AC	HD	M	N	P	S	T
80	125	100	50	10	19j6	40	6	15.5	21.5	M6x16	160	130	156	223	-	-	-	-	-

Electrical Data

Type	BF31D 80M1-2
Poles	2/3000 Poles
Power	0.75 Kw
Voltage	230 V
Frequency	50 Hz
Speed	2800 rpm
Nominal current	4.87 A
Power factor	0.93
Efficiency 100%	72.0 %
Efficiency 75%	- %
Efficiency 50%	- %
Torque	2.56 N.m
Ta/Tn	2.5
Ia/In	6.2
Tm/Tn	1.8

Mechanical Data

Shaft height	80
Construction form	B3
Mechanical protection	55
Heating class	B
Insulation class	F
Service	S3-70%
Ambient temp.	-10°C-40°C
Altitude	1000
Noise	- dB(A)
Weight	9 kg
Bearing DE	6204 2Z C3
Bearing NDE	6204 2Z C3

Extra Data

Applicable brakes

DC brake	REB-05-08	Brake torque	8	N.m
AC brake	NA	Brake torque	NA	N.m

Applicable forced ventilations

Single-phase forced ventilation	Power	45	W
Three-phase forced ventilation	Power	NA	W

Universal Motors S.A.
Rua Comendador Brandão, 484
4495-375 Póvoa de Varzim
geral@universalmotors.pt
TEL.: 252 299 080

Universal Motors UK, Ltd
Unit E2, Meltham Mills Road
West Yorkshire HD9 4AR
enquiries@universalmotors-group.co.uk
TEL.: +44(0) 1484660222

Universal Motors SL
C/La Habana n.6 nave 4 PI Camporoso
28806 Alcala de Henares
info@universalmotors-group.es
TEL.: 918 864 213