

Technical Data Sheet
Electric Motor 1 phase in Aluminum IE2

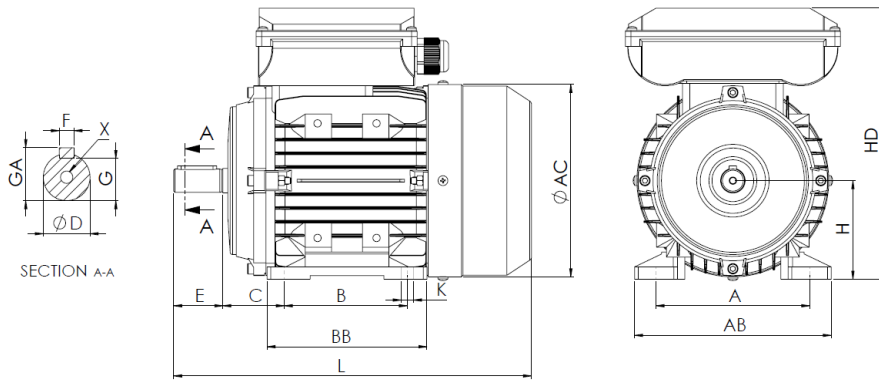

L (standard motor)
431
L (motor w/brake)
510
L (motor w/forced ventilation)
546
L (motor without ventilation)
370

Feet					Shaft						Carcass				Flange				
H	A	B	C	K	D	E	F	G	GA	X	AB	BB	AC	HD	M	N	P	S	T
112	190	140	70	12	28j6	60	8	24	31	M10x22	220	175	221	297	-	-	-	-	-

Electrical Data

Type	UMM2D 112M-4		
Poles	4/1500	Poles	
Power	3.70	Kw	
Voltage	230	V	
Frequency	50	Hz	
Speed	1460	rpm	
Nominal current	19.22	A	
Power factor	0.97		
Efficiency 100%	86.3	%	
Efficiency 75%	87.4	%	
Efficiency 50%	84.3	%	
Torque	24.2	N.m	
Ta/Tn	1.9		
Ia/In	6.5		
Tm/Tn	1.8		

Mechanical Data

Shaft height	112
Construction form	B3
Mechanical protection	55
Heating class	B
Insulation class	F
Service	S1
Ambient temp.	-10°C-40°C
Altitude	1000
Noise	- dB(A)
Weight	34.23 kg
Bearing DE	6306 2Z C3
Bearing NDE	6206 2Z C3

Extra Data

Applicable brakes

DC brake	REB-05-14	Brake torque	60	N.m
AC brake	NA	Brake torque	NA	N.m

Applicable forced ventilations

Single-phase forced ventilation	Power	80	W
Three-phase forced ventilation	Power	NA	W

Universal Motors S.A.
Rua Comendador Brandão, 484
4495-375 Póvoa de Varzim
geral@universalmotors.pt
TEL.: 252 299 080

Universal Motors UK, Ltd
Unit E2, Meltham Mills Road
West Yorkshire HD9 4AR
enquiries@universalmotors-group.co.uk
TEL.: +44(0) 1484660222

Universal Motors SL
C/La Habana n.6 nave 4 PI Camporoso
28806 Alcala de Henares
info@universalmotors-group.es
TEL.: 918 864 213