

| | | |
|--------------------|-------|-----|
| MODEL | 311A | |
| Ø OUTPUT SHAFT | 14 | mm |
| APPROXIMATE RATIO | 3 | |
| EXACT RATIO | 2.84 | |
| OUTPUT SPEED | 487 | RPM |
| EXACT OUTPUT SPEED | 514 | RPM |
| INPUT POWER | 0.37 | KW |
| INPUT ROTATION | 1400 | RPM |
| INPUT PAM | 71B14 | |
| OUTPUT TORQUE | 6.59 | N.m |
| NOMINAL TORQUE | 23.00 | N.m |
| NOMINAL POWER | 1.2 | KW |
| SERVICE FACTOR | 3.24 | |
| DYNAMIC EFFICIENCY | 0.92 | |

Oil Quantity (L)

| B3/H1 | B6/H4 | B7/H3 | B8/H2 | V5/H5 | V6/H6 |
|-------|-------|-------|-------|-------|-------|
| 0.1 | 0.1 | 0.1 | 0.1 | 0.1 | 0.1 |

Radial and Axial Loads



| n_2 [min-1] | F_A [N] | F_R [N] |
|---------------|-----------|-----------|
| 700 | 120 | 640 |
| 400 | 160 | 800 |
| 200 | 200 | 1020 |
| 140 | 225 | 1120 |

Universal Motors S.A.
Rua Comendador Brandão, 484
4495-375 Póvoa de Varzim
geral@universalmotors.pt
TEL.: 252 299 080

Universal Motors UK, Ltd
Unit E2, Meltham Mills Road
West Yorkshire HD9 4AR
enquiries@universalmotors-group.co.uk
TEL.: +44(0) 1484660222

Universal Motors SL
C/La Habana n.6 nave 4 PI Camporroso
28806 Alcala de Henares
info@universalmotors-group.es
TEL.: 918 864 213

P311-F... Output flange
flange di uscita

Gearbox weight
peso riduttore **2.50 kg**



***Available output shaft / Albero di uscita**

| | Shaft - d1 | p1 | h1 | x |
|---------------------------|--------------------|--------|------------|----------------|
| Standard | ø 14x30 | 5 | 16 | M5x13 |
| On request A richiesta | ø 19x40 ø 24x40 | 6 8 | 21.5 27 | M6x16 M6x16 |

Available output flanges / flange di uscita

| a1 ø | b1 | c1 | e1 | f1 | s1 | kit code |
|------|-----|------|-----|-----|----|------------|
| 120 | 80 | 11.5 | 100 | 3 | 9* | KC30.9.010 |
| 140 | 95 | 11.5 | 115 | 3 | 9 | KC30.9.011 |
| 160 | 110 | 11.5 | 130 | 3.5 | 9 | KC30.9.012 |
| 200 | 130 | 11.5 | 165 | 3.5 | 11 | KC30.9.013 |

*Holes position
posizione fori

P311-H1... With feet
Con piedini



R311-N... Input Shaft
Albero in entrata

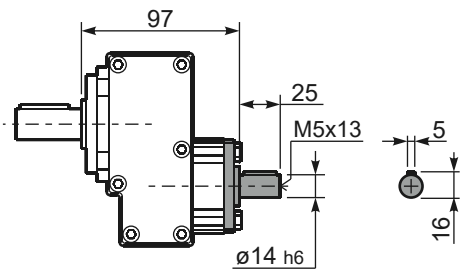

P311-N... Basic gearbox
Riduttore base



| B14 Motor Flanges | A | g6 | k1 | kit code |
|-------------------|-------|-----|-------|------------|
| 56 B14 | 103 | 80 | 106.5 | KC40.4.049 |
| 63 B14 | 105.5 | 90 | 109 | K050.4.047 |
| 71 B14 | 103 | 105 | 106.5 | K050.4.045 |

| B5 Motor Flanges | A | g6 | k1 | kit code |
|------------------|-------|-----|-------|------------|
| 63 B5 | 105.5 | 138 | 109 | K050.4.041 |
| 71 B5 | 103 | 160 | 106.5 | K050.4.042 |