

Technical Data Sheet
Gearbox
WORM GEARBOX SQUARE DESIGN



| | | |
|--------------------|--------|-----|
| MODEL | Q75 | |
| Ø OUTPUT SHAFT | 30 | mm |
| APPROXIMATE RATIO | 50 | |
| EXACT RATIO | 50.00 | |
| OUTPUT SPEED | 29 | RPM |
| EXACT OUTPUT SPEED | 29 | RPM |
| INPUT POWER | 1.10 | KW |
| INPUT ROTATION | 1400 | RPM |
| INPUT PAM | 90B5 | |
| OUTPUT TORQUE | 255.10 | N.m |
| NOMINAL TORQUE | 220.00 | N.m |
| NOMINAL POWER | 0.95 | KW |
| SERVICE FACTOR | 0.86 | |
| DYNAMIC EFFICIENCY | 0.68 | |



Oil Quantity (L)

| B3/H1 | B6/H4 | B7/H3 | B8/H2 | V5/H5 | V6/H6 |
|-------|-------|-------|-------|-------|-------|
| 0.4 | 0.4 | 0.4 | 0.4 | 0.4 | 0.4 |

Radial and Axial Loads



| n_2 [min ⁻¹] | FA [N] | FR [N] |
|----------------------------|--------|--------|
| 200 | 460 | 2300 |
| 100 | 560 | 2800 |
| 50 | 720 | 3600 |
| 15 | 1000 | 5000 |

Universal Motors S.A.
Rua Comendador Brandão, 484
4495-375 Póvoa de Varzim
geral@universalmotors.pt
TEL.: 252 299 080

Universal Motors UK, Ltd
Unit E2, Meltham Mills Road
West Yorkshire HD9 4AR
enquiries@universalmotors-group.co.uk
TEL.: +44(0) 1484660222

Universal Motors SL
C/La Habana n.6 nave 4 PI Camporoso
28806 Alcalá de Henares
info@universalmotors-group.es
TEL.: 918 864 213

PQ75FB... Basic wormbox
Riduttore base

Gearbox weight
peso riduttore **8.70 kg**

| M. flanges | Kit code | øF | A |
|------------|------------|-----|-----|
| 71B5 | K023.4.041 | 160 | 114 |
| 80/90B5 | K023.4.042 | 200 | 116 |
| 100/112B5 | K023.4.043 | 250 | 125 |
| 80B14 | K085.4.046 | 120 | 116 |
| 90B14 | K085.4.045 | 140 | 116 |
| 100/112B14 | K085.4.047 | 160 | 125 |



PQ75FC... Square flange
Flangia quadrata



PQ75FL... Square flange
Flangia quadrata



PQ75FB... Feet
Piedini



PQ75BR... Reaction arm
Braccio di reazione



RQ75FB... Input shaft
Albero in entrata

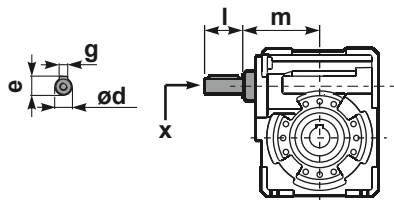

PQ75....S... Single Shaft
Albero lento semplice

PQ75....D... Double Shaft
Albero lento bisp.



① kit cod. KQ75.5.028 Standard
kit cod. KQ75.5.026 On request
② kit cod. KQ75.5.029 Standard

| | ød | e | g | l | m | x | kit code |
|--------|-------|------|---|----|-------|-------|---|
| type B | 25 h6 | 27.8 | 8 | 50 | 109.5 | M8x20 | KQ75.5.006 PAM80 K085.5.007 PAM90 K085.5.008 PAM100 |

| | b1 | c1 | d1 | e1 | f1 | l1 | m1 | n1 | t2 | o1 |
|------------|----|----|--|----|-----|-----|-----|-----|----|-------|
| Standard | 8 | 60 | 30 ^{-0.005} _{-0.020} | 65 | 127 | 255 | 134 | 199 | 33 | M8x20 |
| On request | 8 | 60 | 28 ^{-0.005} _{-0.020} | 65 | - | - | 134 | 199 | 31 | M8x20 |